

Key fob

R1

User Manual

Key fob R1

Model	R1
Dimensions	60.6mm x 29mm x 11.7mm
Material	Plastic
Frequency	2.4GHz
Power supply	CR2032
Voltage	3V
Number of openings	>10000
Idle current	<2uA

Button and light illustration

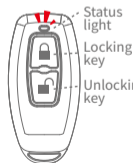

Status light

Locking key

Unlocking key

Unlocking: Press the unlocking key to unlock, the status light flickers.

Locking: Press the locking key to lock, the status light flickers.

Low power: The status light flickers slowly on locking/unlocking.

Add key fob to a lock in APP

- 1 Activate the APP, select the lock you want to add a key fob.



- 2 Press Wireless key fob.



- 3 Press "Add key fob"

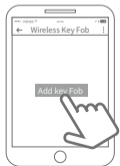

- 4 Select the time frame, fill in the name and press "Next."



- 6 Press the device that has an "+" icon to complete.



- 5 Press the locking key for 5 seconds till status light flickers, then press "Next"

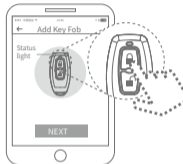

Replace battery

- 1 Remove the cover of the key fob.
- 2 Remove the mainboard from the housing.

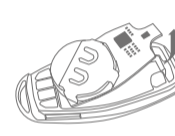
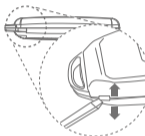

- 3 Replace the battery and reinstall the cover.



Limited Warranty

1. For any defect in material and workmanship, the original purchaser of the product can:
 - 1) Return or ask for a replacement within 7 invoice days.
 - 2) Ask for a replacement within 15 invoice days.
 - 3) Ask for free repair in 365 invoice days.
2. This warranty does not cover defects caused by modification, alteration, misuse or physical abuse of the product.

Disclaimer

We continuously optimize products as new technologies and features are developed. For this reason, we reserve the right to make alterations to the products without prior notice.