



WIFI DIGITAL DOOR VIEWER User Manual

(Tuya Version)

App Download and Installation

(this manual take Huawei mobile phone as an example to explain how to use the device)



App: Tuya Smart

Step1: Open App Store (for iOS) or Google Play Store(for Android outside China) or Yingyongbao Store (for android inside China)on your mobile, search for "Tuya Smart", or scan QR code above to download the APP and install it.

Step2: Modify the "App launch" setting.

Setting path: mobile >>>settings>>>Apps>>>App launch

Find the App (Tuya Smart), change the setting from "Manager automatically" to "manage manually" and take effect the "Auto-launch", "Secondary launch" and "Run in background" (If don't change this setting, your mobile may can't receive the device's message)

Step3: Open all permission required for this App

Setting path: mobile >>>settings>>>Apps>>>Permissions

Open all permission required for this App

Account Registration / Login

New users need to register a new account, and then log in with a user name and Password

Device Addition and Network Configuration

Note: ① This device can only work with 2.4GHz Wi-Fi signal. So, please check your router and make sure it works at 2.4GHz. When configuring the network, please keep the product and mobile phone as close to the wireless router as possible to ensure good network signal.

② Please operate the following steps 1-4 in strict order.

③ In the process of network configuration, if you hear the host prompt "configure network timeout" or the interface shows that the network configuration fails, please exit the app and restart the product, and then re operate from step 1.

Step1: Open and log in the app, click "add device", and select "video Surveillance" in the left product catalog, as shown in (figure 1). Then select "Smart Doorbell" in the product type on the right, and the interface as shown in (Figure 2) will appear.

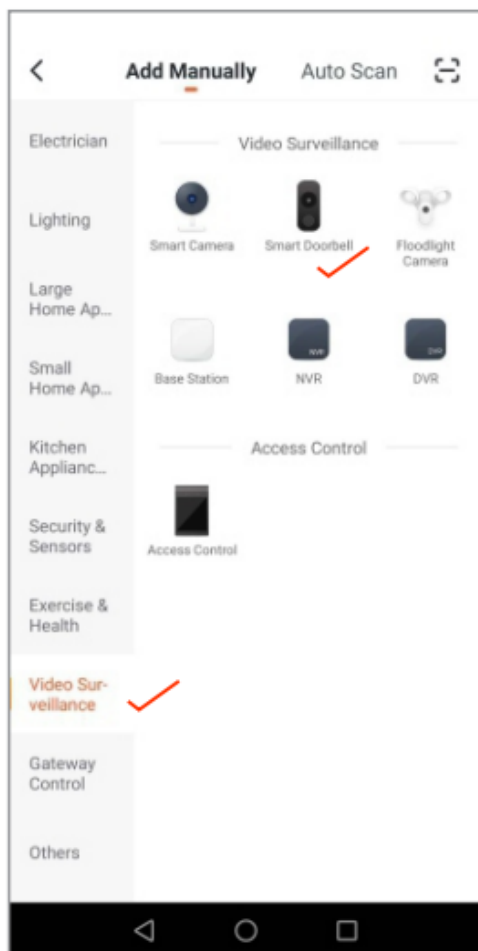

Figure1

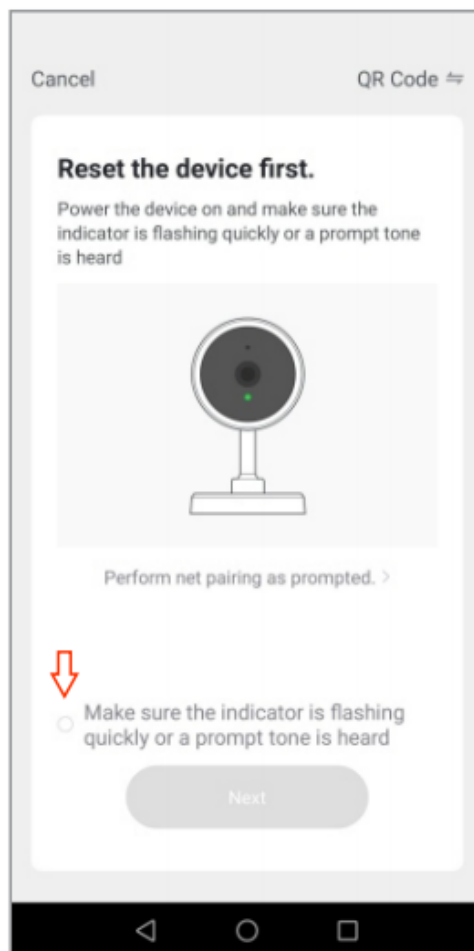

Figure2

Step2: Take out the outdoor unit and indoor unit of the device (host), and connect the cable of outdoor unit to the back of the host, as shown in (figure3). Long press the **【middle key】** of the host for 3 seconds to start up. Then long press the **【right key】** for 5 seconds to enter the network configuration mode, at this time, the host will have a voice prompt " Please use APP to setup network", and you will see the blue indicator flashes (flashes once in 1 second) on the host.

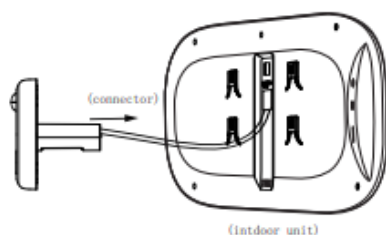

Figure3



Figure4

- Step3: When hearing the voice prompt of "please use app to setup the network " and see the blue indicator flashes (flashes once in 1 second), please select the reminder "make sure the indicator is flashing quickly or a prompt tone is heard" on mobile APP (figure 2), and then click "next" , a new interface will pop up (figure 5)
- Step4: Input Wi-Fi user name and password in (figure 5). Then click "NEXT", it will pop up a interface of QR code scanning reminder, click "continue" to pop up the interface of QR code (figure 6). At this time, aim the camera lens at the QR code, keep a distance of 15-20cm, adjust the distance before the camera appropriately. When the host sends a voice prompt "Connecting network", click the option "hear voice prompt" in the interface (figure 6), and the interface "adding device" appears (figure 7). After about 30 seconds, when the host voice prompt "network setup successfully", the network configuration ends, and the interface of (figure 8) appears. Click "Done" and then click "Security camera" to enter the video interface.



Figure5



Figure6

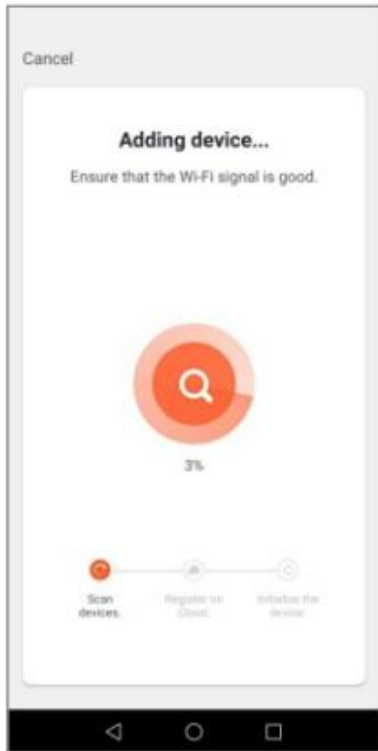

Figure7

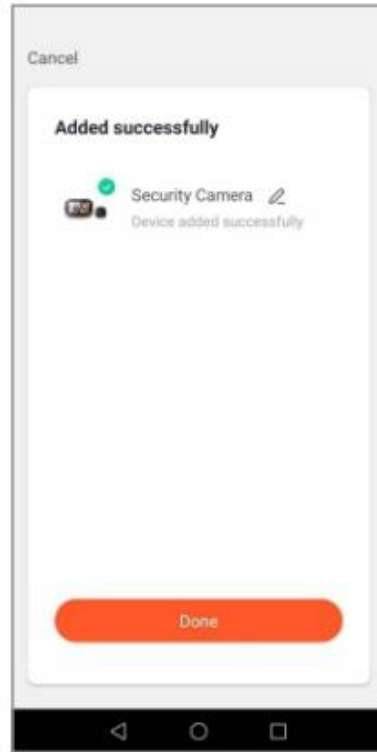

Figure8



Figure9

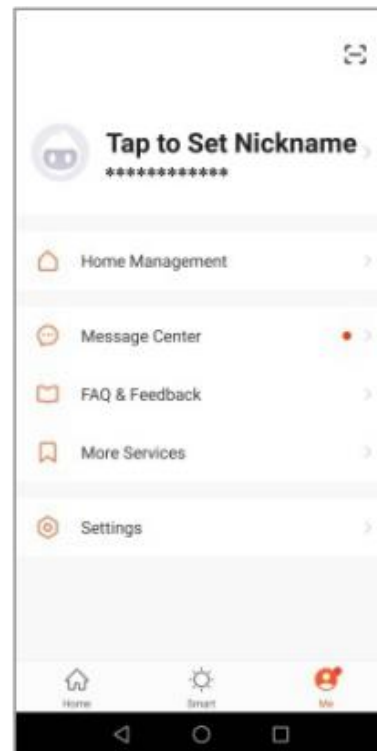
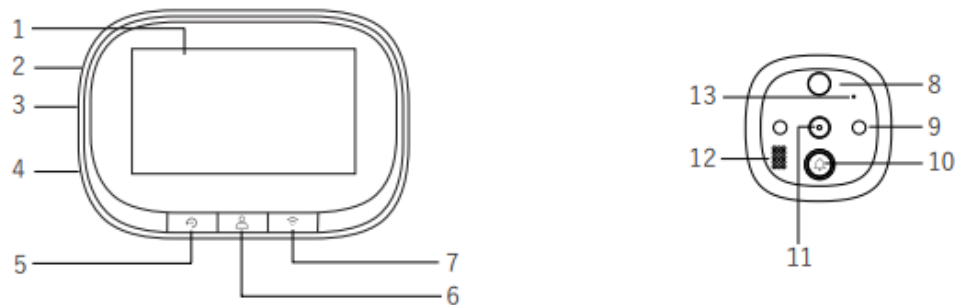

Figure10

Device Settings and App Settings

1. Device settings: when the mobile phone and the device are connected, the device can be set online.
Setting method: click the "pencil" symbol in the upper right corner of the video window, then the device setting interface pops up, as shown in (figure 9).
Note: when the phone is disconnected from the device, the device cannot be set.
2. App settings: exit the video window of app, click "me" in the lower right corner of APP, then the App setting interface pops up, as shown in (figure 10).

Product Outline



- 1.LCD display 2.Reset key 3.Battery charging port 4.TF Card slot
5.Left key(Restore factory settings key) 6.Middle key(Monitor key/ power key)
7.Right key (Network configuration key) 8.PIR sensor 9. IR LED 10. Doorbell key
11.Camera 12.Speaker 13.Micro phone

Key Function Description

Left key(Restore factory settings key): When the screen is on, long press this key for 10 seconds, the device will return to the factory settings.

Middle key(Monitor key/ power key): Long press this key for 3 seconds to turn on / off the device, click this key to turn on / off the screen.

Right key (Network configuration key): in the power on state, long press this key for 5 seconds to enter the network configuration mode, and long press this key again for 5 seconds to exit the network configuration mode.

Doorbell key: press this key to wake up the doorbell host, ring and call the connected mobile phone.

Device Parameter

Support OS: Android and iOS
Camera Pixel: 720P
LCD Screen: 4.3Inch , IPS, 480*272
Battery capacity: 3500mAh

Two way Audio: support
Motion detection: support
External storage: Micro SD card (128GB maximum)
IR LED wave length: 940nm (invisible light)
Battery Charger: 5V / 2A
Suitable for door hole: diameter 14-35mm
Applicable door thickness range: 35-100mm
Wireless WIFI: ieee802.11b/g/n 2.4GHz

How to Install The Device on The Door

- Step 1: According to the thickness of the door to select a suitable bolt, then, screw the bolt into the hole (refer installation icon 1)
- Step2: Tear off double-side adhesive protective film on the back of the outdoor part, insert the unit barrel together with the FPC cable through the peephole of the door, then stick the outdoor part on door(motion detection is upward, doorbell key is downward)
- Step3: Take out the metal bracket (the "UP" arrow on the bracket means upward), pass the FPC cable through the rectangular hole, the right screw through the round of the metal bracket, then lock the metal bracket with the outdoor unit tightly.
- Step4: Insert TF card to the indoor unit.
- Step5: Connect the FPC cable from outdoor part to the connector of the indoor part (pay attention to the right direction)
- Step6: The four slots on the back of indoor part is aligned with four projection on metal bracket and buckle up, then pull down the outdoor part to lock tightly.

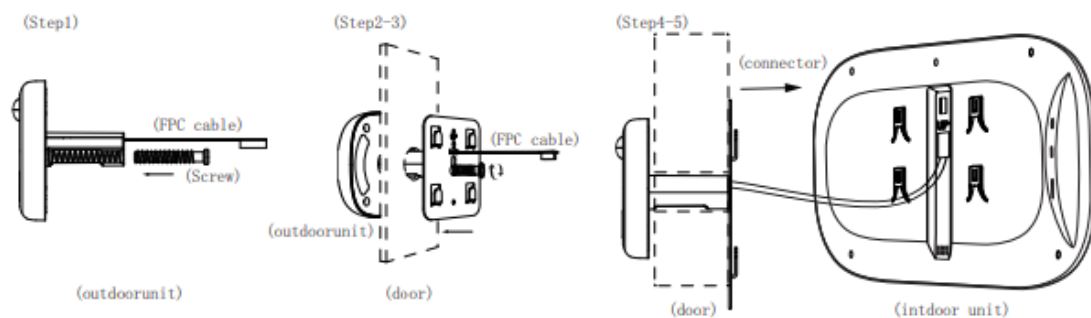

Packing List

Indoor unit x1 Outdoor unit x1 Metal bracket x1 Screw x3 Power Cable x1 User manual x1